

5/3 Way Valves Series S9

G1/8

Actuation systems:

- Hand lever
- Safety hand lever
- Pneumatic
- Electrical pilot operated

Versions:

- With external pilot air
- Version to ATEX Standard

Weight (mass) kg

Description	Type *	Weight (mass)
Hand lever	S9 511.-1/8	0,195
- with spring return	S9 511RF.-1/8	0,195
Safety hand lever	S9 511S.-1/8	0,195
Pneumatic, by permanent signal	S9 561RF.-1/8	0,180
Electrical, by permanent signal	S9 581RF.-1/8	0,425
Electrical, by permanent signal	S9 581S-RF.-1/8	0,425

* Type code for middle position functions

G = middle position closed

E = middle position exhausted

B = middle position pressurized

Hand lever actuated – Type: S9 511.-1/8, S9 511RF.-1/8

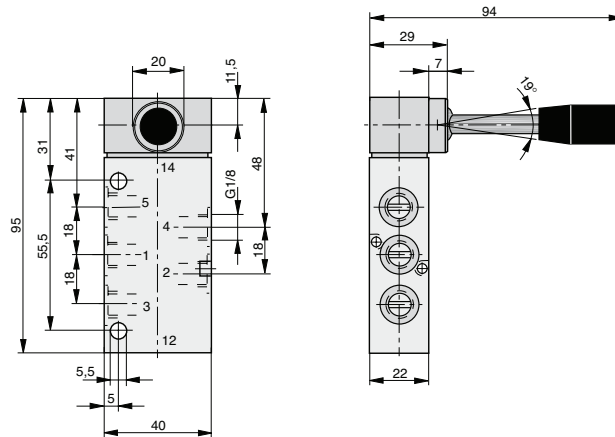

Safety hand lever actuated – Type: S9 511S.-1/8

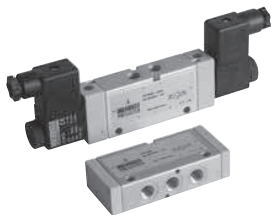
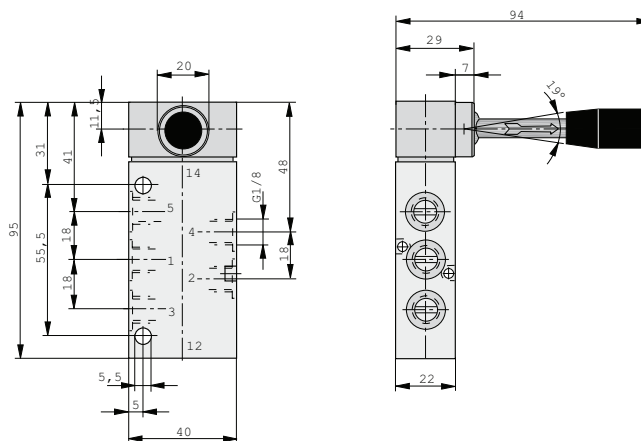

Pneumatically actuated – Type: S9 561RF-1/8

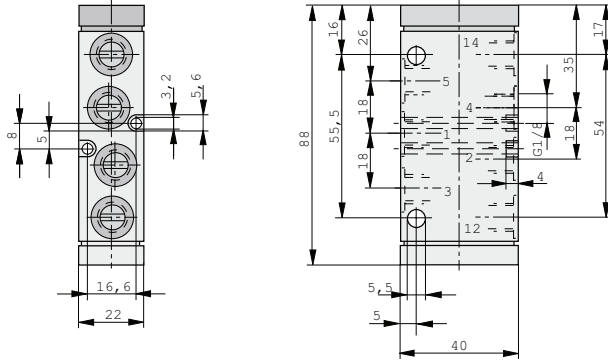

Electrically actuated – Type: S9 581(S)-RF-1/8

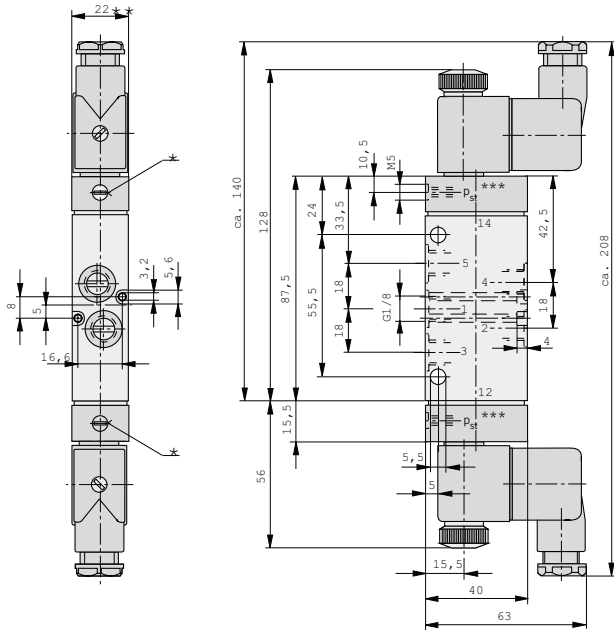

**Solenoid for use in EX areas
Dimensions**

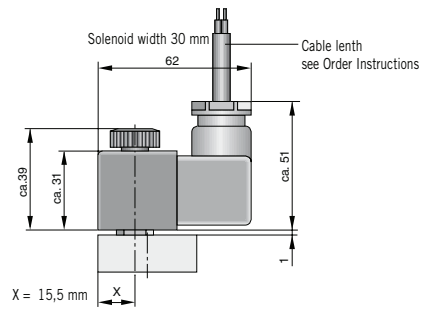





For more information on valves to ATEX standards see page 46, 47, 77

- * Manual override
- ** Solenoid width = 30 mm on low wattage coil version
- *** Operating pressure supply p_{st} only for type S9 581S

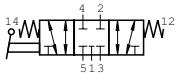
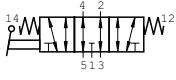
For order instructions see page 75-77, characteristics see page 44-47

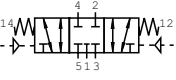
Dimensions in mm

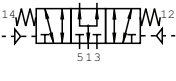
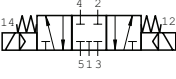
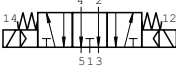
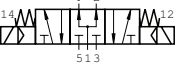
Actuation System	Symbol	Order Instructions		Page	
		Type	Order No.		
Rotary lever, spring return to middle position		S9 512RFG-1/4	PA 12699	67	
		S9 512RFG-1/2	PA 16383	69	
		S9 512RFE-1/4	PA 12700	67	
		S9 512RFE-1/2	PA 16384	69	
		S9 512RFB-1/4	PA 12701	67	
		S9 512RFB-1/2	PA 16385	69	
Pneumatic, by permanent signal		S9 561RFG-1/8	PA 10330	65	
		S9 561RFG-1/4	PA 12702	67	
		S9 561RFG-1/2	PA 16168	69	
	spring return to middle position		S9 561RFE-1/8	PA 10331	65
			S9 561RFE-1/4	PA 12703	67
			S9 561RFE-1/2	PA 16169	69
		S9 561RFB-1/8	PA 10332	65	
		S9 561RFB-1/4	PA 12704	67	
		S9 561RFB-1/2	PA 16170	69	
Electrical by permanent signal		S9 581RFG-1/8-..	PA 10333-..33	65	
		S9 581RFG-1/4-..	PA 12705-..33	67	
		S9 581RFG-1/2-..	PA 16176-..33	69	
	spring return to middle position		S9 581RFE-1/8-..	PA 10334-..33	65
			S9 581RFE-1/4-..	PA 12706-..33	67
			S9 581RFE-1/2-..	PA 16177-..33	69
		S9 581RFB-1/8-..	PA 10335-..33	65	
		S9 581RFB-1/4-..	PA 12707-..33	67	
		S9 581RFB-1/2-..	PA 16178-..33	69	

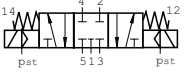
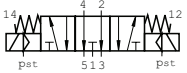
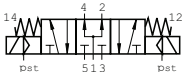

For complete Type- and Order No. - see page 77

Actuation System	Symbol	Order Instructions		Page
		Type	Order No.	
Electrical by permanent signal		S9 581S-RFG-1/8-..	PA 10377-...33	65
		S9 581S-RFG-1/4-..	PA 12925-...33	67
spring return to middle position		S9 581S-RFE-1/8-..	PA 10379-...33	65
		S9 581S-RFE-1/4-..	PA 12923-...33	67
with external pilot air		S9 581S-RFB-1/8-..	PA 10378-...33	65
		S9 581S-RFB-1/4-..	PA 12924-...33	67

Solenoid version	Nominal voltage	Applicable for	Key code	ATEX Type additon
Standard version	230V 50/60Hz	110 V =	61	-
	24V =	60V 50/60Hz	02	-
Low wattage version	24V =		13	-
	230V 50/60Hz		69	-

EX Area versions to ATEX Standard

Category, type of ignition protection

Single valve: Ⓢ II 2G c T4 T135°C -10°C ≤ Ta ≤ +60°C

Solenoid/individual use: Ⓢ II 2G EEx m II T5 -20°C ≤ Ta ≤ +50°C

Solenoid/manifold mounting: Ⓢ II 2G EEx m II T5 -20°C ≤ Ta ≤ +40°C

Solenoid version	Nominal voltage	Applicable for	Key code	ATEX Type additon
Solenoid	24V =		48	ATEX
- with cable 1.2 m				
- with cable 3 m	24V =		45	ATEX
- with cable 5 m	24V =		46	ATEX
- with cable 10 m	24V =		47	ATEX
- with cable 1.2 m	24V 50/60Hz		99	ATEX
- with cable 1.2 m	110V 50/60Hz		97	ATEX
- with cable 1.2 m	230V 50/60Hz		98	ATEX

Example for valves in ATEX-Version:

- for valves Series S9-G1/8, S9-G1/4, S9-G1/2

Please add behind the Standard Order No. "ATEX"

Type: S9 581RFG-1/8-4633

Order No. PA10333-4633ATEX