

Suction lines are a user-friendly, pre-prepared installation aid to connect the suction side of a dosing pump to the medium to be dosed. Depending on the application and the medium to be used, we offer different versions in terms of their function and the materials used. The models shown here can be used with Lutz-Jesco dosing pumps or with those of other manufacturers. Depending on the type, there are various electrical and hydraulic connection versions. The possibilities are shown in the overview below. Detailed information can be found in the product descriptions on the following pages.

Nominal widths and flow rates: DN4 - 25 l/h, DN6 - 50 l/h, DN10 200 l/h, DN15 - 400 l/h, DN25 - 1000 l/h

Functions	Suction lines										Base valves						Level control			
	SA	SC	SG-2	GF-2	SDL-2	SH	SL	SL-2	FA	FB	FC	FD	FK	NB	NB-2	ND	ND-2			
Flexible design	X						X							X						
Rigid design		X	X			X										X	X			
Rigid design with protective tube				X																
Base valve with non-return function and filter	X	X	X			X	X	X	X	X	X	X	X							
Base valve with non-return function				X																
Connection to medium return		0	0	X																
1st level switch* (switching point)							X							X		X				
2nd level switch* (switching point)			X	X	X										X		X			
PVC material with PP float			X																	
PVC material	X	X	X	X	X	X	X	X	X	X	X	X	X	X	X	X	X			
PP material	X		X					X					X				X			
PVDF material	X		X					X				X					X			
Stainless steel material	X								X		X									
PVC hose material	X	X	X	X	X		X	X												
PE hose material	X		X					X												
PTFE hose material	X		X					X												
Electrical connection 3.5 mm jack plug							X	X						X	X	X	X			
Electrical connection M12x1 female connector, a-coded			X	X				X							X		X			
Electrical connection with wire, no plug			0	0	X			0						0	0	0	0			

x = standard
0 = optional

*) max contact load rating: 50 V DC/AC, 0.5 A, Pmax 10 VA (50 V DC/AC, 1 A, Pmax 20 VA for SDL-2 DN10)

use contact protection relays for inductive loads

Selection guide for suction lines

Accessories	Suction lines
-------------	---------------

Flexible suction line, SA model with foot valve and load part made from ceramic, soft PVC hose 2,5 m

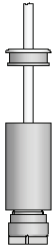

Suction line Type SA, flexible	Nominal width	Hose		Part No.	Price [EUR]
		$\varnothing_i/\varnothing_a$	Material		
PVC	DN4	4/6	PVC	12224451	30.80
	DN6	6/9 and 1/4x3/8"	PVC	12234731	46.30
	DN6	6/12	PVC	12224761	46.30
	DN6	9/12 and 3/8x1/2"	PVC	12200806	52.80
	DN10	9/15	PVC	12200301	91.30
	DN15	13/20	PVC	12200223	220.60
PP	DN4	4/6	PE	12234720	33.90
	DN6	6/9	PE	12200410	53.20
	DN6	1/4x3/8"	PE	12200433	53.20
	DN6	6/12	PVC	12200217	66.00
	DN6	9/12	PE	12200810	59.70
	DN10	3/8x1/2"	PE	12200811	59.70
PVDF	DN4	4/6	PTFE	12200411	98.80
	DN6	6/8	PTFE	12200161	144.30
	DN6	6/9	PTFE	12200211	144.30
	DN6	1/4x3/8"	PTFE	12200425	144.30
	DN6	6/12	PVC	12200405	144.30
	DN6	9/12	PTFE	12200807	150.90
	DN10	3/8x1/2"	PTFE	12200808	150.90
stainless steel/ FPM	DN4	4/6	PTFE	12200520	181.10
	DN6	6/9	PTFE	12200568	269.70
	DN6	1/4x3/8"	PTFE	12200569	269.70
	DN6	9/12	PTFE	12200684	276.30
	DN10	3/8x1/2"	PTFE	12200685	276.30
Stainless steel/ EPDM	DN4	4/6	PTFE	12200570	181.10
	DN6	6/9	PTFE	12200571	269.70
	DN6	1/4x3/8"	PTFE	12200572	269.70
	DN6	9/12	PTFE	12200686	276.30
	DN10	3/8x1/2"	PTFE	12200687	276.30

Suction lines

Accessories Suction lines

Rigid suction line, type SC with foot valve DN6, adjustable length,
 Suitable connection see connection table (page 1 - 277), must be ordered separately if required.
 Suitable suction hose see hose table (page 1 - 286), must be ordered separately if required.



Suction line Type SC, rigid	Nominal width	Suction line Length	Suction line for tank	Connection	Material Seal	Part No.	Price [EUR]
PVC	DN6	435 mm	45 l	G5/8 male	FPM	12201135	56.80
	DN6	500 mm	35 l	G5/8 male	FPM	12201136	56.80
	DN6	540 mm	75 l	G5/8 male	FPM	12201137	56.80
	DN6	710 mm	100 l	G5/8 male	FPM	12201138	56.80
	DN6	800 mm	200 l	G5/8 male	FPM	12201139	56.80
	DN6	950 mm	300 l	G5/8 male	FPM	12201140	56.80
	DN6	1100 mm	500 l	G5/8 male	FPM	12201141	56.80
	DN6	1160 mm	1000 l	G5/8 male	FPM	12201142	56.80
	DN6	1400 mm	1000 l	G5/8 male	FPM	12201143	56.80
	DN6	435 mm	45 l	G5/8 male	EPDM	12201154	56.80
	DN6	500 mm	35 l	G5/8 male	EPDM	12201155	56.80
	DN6	540 mm	75 l	G5/8 male	EPDM	12201156	56.80
	DN6	710 mm	100 l	G5/8 male	EPDM	12201157	56.80
	DN6	800 mm	200 l	G5/8 male	EPDM	12201158	56.80
	DN6	950 mm	300 l	G5/8 male	EPDM	12201159	56.80
	DN6	1100 mm	500 l	G5/8 male	EPDM	12201160	56.80
	DN6	1160 mm	1000 l	G5/8 male	EPDM	12201161	56.80
	DN6	1400 mm	1000 l	G5/8 male	EPDM	12201162	56.80

Rigid suction line, type SG-2 with foot valve, fixed installation position: 925 mm., level monitoring and low level alert with 2 switching points, switching distance ~ 34 mm, switch function: Closer with rising level, electrical connection to dosing pump with A-coded plug connector M12x1, grommet d 12 mm for return hose with integrated ventilation valve (fitting adapter cable for pumps of the type LT / DE / DX article no. 79407 can be found on page 1 - 290)



Suction line Type SG-2, rigid	Nominal width	Suction line Length	Suction line for tank	Hose Øi/Øa	Material	Part No.	Price [EUR]
PVC, FPM	DN25	950 mm	IBC container	Stick-on connection Ø32	PVC	12200927	664.70
PVC, EPDM	DN25	950 mm	IBC container	Stick-on connection Ø32	PVC	12200928	664.70

Accessories Suction lines

Rigid suction line, type SG-2 with foot valve DN6, adjustable length, Level control with low level alert with 2 switching points, switching distance ~ 60 mm switch function: Closer with rising level, electrical connection to dosing pump with A-coded plug connector M12x1, (fitting adapter cable for pumps of the type LT / DE / DX article no. 79407 can be found on page 1 - 290)
 Suitable connection see connection table (page 1 - 277), must be ordered separately if required.
 Suitable suction hose see hose table (page 1 - 286), must be ordered separately if required.



Suction line Type SG-2, rigid	Nominal width	Suction line Length	Suction line for tank	Connection	Material Seal	Part No.	Price [EUR]
PVC	DN6	540 mm	75 l	G5/8 male	FPM	12201121	100.40
	DN6	435 mm	45 l	G5/8 male	FPM	12201127	100.40
	DN6	500 mm	35 l	G5/8 male	FPM	12201128	100.40
	DN6	710 mm	100 l	G5/8 male	FPM	12201129	100.40
	DN6	800 mm	200 l	G5/8 male	FPM	12201130	100.40
	DN6	950 mm	300 l	G5/8 male	FPM	12201131	100.40
	DN6	1100 mm	500 l	G5/8 male	FPM	12201132	100.40
	DN6	1160 mm	1000 l	G5/8 male	FPM	12201133	100.40
	DN6	1400 mm	1000 l	G5/8 male	FPM	12201134	100.40
	DN6	435 mm	45 l	G5/8 male	EPDM	12201145	100.40
	DN6	540 mm	75 l	G5/8 male	EPDM	12201146	100.40
	DN6	500 mm	35 l	G5/8 male	EPDM	12201147	100.40
	DN6	710 mm	100 l	G5/8 male	EPDM	12201148	100.40
	DN6	800 mm	200 l	G5/8 male	EPDM	12201149	100.40
	DN6	950 mm	300 l	G5/8 male	EPDM	12201150	100.40
	DN6	1100 mm	500 l	G5/8 male	EPDM	12201151	100.40
	DN6	1160 mm	1000 l	G5/8 male	EPDM	12201152	100.40
	DN6	1400 mm	1000 l	G5/8 male	EPDM	12201153	100.40

Connection with G5/8 union nut for suction hose	Description	Material	Part No.	Price [EUR]
	Hose clamp connection for tube 4/6 mm	PVC	20975	13.10
	Hose clamp connection for tube 6/8 mm	PVC	39702	18.70
	Hose clamp connection for tube 6/9 mm	PVC	34925	13.10
	Hose clamp connection for tube 1/4x3/8"	PVC	37295	19.40
	Hose clamp connection (short version) for tube 6/12 mm	PVC	32980	13.10
	Hose clamp connection (long version) for tube 6/12 mm	PVC	19180	13.10
	Hose clamp connection for tube 1/4x7/16"	PVC	33623	22.90
	Hose clamp connection for tube 9/12 mm	PVC	39791	50.00
	Hose clamp connection for tube 3/8x1/2"	PVC	40032	50.00
	Hose clamp connection for hose Ø6 mm female	PVC	23092	12.30
	Hose clamp connection for hose Ø9 - 10 mm female	PVC	37690	19.60
	Glue-in connection for pipe Ø10 male	PVC	23087	7.80
	Glue-in connection for pipe Ø20 female	PVC	23089	7.80
	Glue-in connection for pipe Ø16 male	PVC	37876	19.30
	Glue-in connection for pipe G1/4 male	PVC	23088	12.90
	Threaded connection 1/4" NPT male	PVC	32408	15.10
	Glue-in connection for pipe G3/8 male	PVC	98538	53.80

Other connections on request.

Suction lines

Accessories

Suction lines

Rigid suction line, type SG-2 with foot valve DN4, adjustable length, hose length 1500 mm.
 Level control with low level alert with 2 switching points switching distance ~ 70 mm switch function: Closer with rising level, electrical connection to dosing pump with A-coded plug connector M12x1, (fitting adapter cable for pumps of the type LT / DE / DX article no. 79408 can be found on page 1 - 290)



Suction line Type SG-2, rigid	Nominal width	Suction line Length	Suction line for tank	Hose Øi/Øa	Material	Part No.	Price [EUR]
PP	DN4	500 mm	35 l	4/6	PE	12200587	261.30
	DN4	540 mm	75 l	4/6	PE	12200588	261.30
	DN4	710 mm	100 l	4/6	PE	12200589	274.00
	DN4	800 mm	200 l	4/6	PE	12200590	274.00
	DN4	950 mm	300 l	4/6	PE	12200591	274.00
	DN4	1100 mm	500 l	4/6	PE	12200592	286.10
	DN4	1160 mm	1000 l	4/6	PE	12200593	286.10
	DN4	1400 mm	1000 l	4/6	PE	12200667	286.10
	DN4	500 mm	35 l	6/9 and 1/4x3/8"	PE	12200594	261.30
	DN4	540 mm	75 l	6/9 and 1/4x3/8"	PE	12200595	261.30
	DN4	710 mm	100 l	6/9 and 1/4x3/8"	PE	12200596	274.00
	DN4	800 mm	200 l	6/9 and 1/4x3/8"	PE	12200597	274.00
	DN4	950 mm	300 l	6/9 and 1/4x3/8"	PE	12200598	274.00
	DN4	1100 mm	500 l	6/9 and 1/4x3/8"	PE	12200599	286.10
	DN4	1160 mm	1000 l	6/9 and 1/4x3/8"	PE	12200600	286.10
	DN4	1400 mm	1000 l	6/9 and 1/4x3/8"	PE	12200668	286.10
	DN4	500 mm	35 l	6/12	PVC	12200601	261.30
	DN4	540 mm	75 l	6/12	PVC	12200602	261.30
	DN4	710 mm	100 l	6/12	PVC	12200603	274.00
	DN4	800 mm	200 l	6/12	PVC	12200604	274.00
	DN4	950 mm	300 l	6/12	PVC	12200605	274.00
	DN4	1100 mm	500 l	6/12	PVC	12200606	286.10
	DN4	1160 mm	1000 l	6/12	PVC	12200607	286.10
	DN4	1400 mm	1000 l	6/12	PVC	12200669	286.10
	DN4	500 mm	35 l	9/12	PE	12200740	453.90
	DN4	540 mm	75 l	9/12	PE	12200741	453.90
	DN4	710 mm	100 l	9/12	PE	12200742	466.80
	DN4	800 mm	200 l	9/12	PE	12200743	466.80
	DN4	950 mm	300 l	9/12	PE	12200744	466.80
	DN4	1100 mm	500 l	9/12	PE	12200745	472.50
	DN4	1160 mm	1000 l	9/12	PE	12200746	472.50
	DN4	1400 mm	1000 l	9/12	PE	12200747	472.50
	DN4	500 mm	35 l	3/8x1/2"	PE	12200748	453.90
	DN4	540 mm	75 l	3/8x1/2"	PE	12200749	453.90
	DN4	710 mm	100 l	3/8x1/2"	PE	12200750	466.80
	DN4	950 mm	300 l	3/8x1/2"	PE	12200752	466.80
	DN4	1100 mm	500 l	3/8x1/2"	PE	12200753	472.50
	DN4	1160 mm	1000 l	3/8x1/2"	PE	12200754	472.50
	DN4	1400 mm	1000 l	3/8x1/2"	PE	12200755	472.50

Accessories Suction lines

Rigid suction line, type SG-2 with foot valve DN4, adjustable length, hose length 1500 mm.
 Level control with low level alert with 2 switching points switching distance ~ 70 mm switch function: Closer with rising level, electrical connection to dosing pump with A-coded plug connector M12x1, (fitting adapter cable for pumps of the type LT / DE / DX article no. 79408 can be found on page 1 - 290)



Suction line Type SG-2, rigid	Nominal width	Suction line Length	Suction line for tank	Hose Øi/Øa	Hose Material	Part No.	Price [EUR]
PVDF	DN4	500 mm	35 l	4/6	PTFE	12200618	385.60
	DN4	540 mm	75 l	4/6	PTFE	12200619	385.60
	DN4	710 mm	100 l	4/6	PTFE	12200620	401.00
	DN4	800 mm	200 l	4/6	PTFE	12200621	401.00
	DN4	950 mm	300 l	4/6	PTFE	12200622	401.00
	DN4	1100 mm	500 l	4/6	PTFE	12200623	416.60
	DN4	1160 mm	1000 l	4/6	PTFE	12200624	416.60
	DN4	1400 mm	1000 l	4/6	PTFE	12200664	416.60
	DN4	500 mm	35 l	6/9	PTFE	12200626	385.60
	DN4	540 mm	75 l	6/9	PTFE	12200627	385.60
	DN4	710 mm	100 l	6/9	PTFE	12200628	401.00
	DN4	800 mm	200 l	6/9	PTFE	12200629	401.00
	DN4	950 mm	300 l	6/9	PTFE	12200630	401.00
	DN4	1100 mm	500 l	6/9	PTFE	12200631	416.60
	DN4	1160 mm	1000 l	6/9	PTFE	12200632	416.60
	DN4	1400 mm	1000 l	6/9	PTFE	12200665	416.60
	DN4	500 mm	35 l	9/12	PTFE	12200724	416.60
	DN4	540 mm	75 l	9/12	PTFE	12200725	416.60
	DN4	710 mm	100 l	9/12	PTFE	12200726	435.20
	DN4	800 mm	200 l	9/12	PTFE	12200727	435.20
	DN4	950 mm	300 l	9/12	PTFE	12200728	435.20
	DN4	1100 mm	500 l	9/12	PTFE	12200729	447.40
	DN4	1160 mm	1000 l	9/12	PTFE	12200730	447.40
	DN4	1400 mm	1000 l	9/12	PTFE	12200731	447.40
	DN4	500 mm	35 l	1/4x3/8"	PTFE	12200633	398.00
	DN4	540 mm	75 l	1/4x3/8"	PTFE	12200634	398.00
	DN4	710 mm	100 l	1/4x3/8"	PTFE	12200635	416.40
	DN4	800 mm	200 l	1/4x3/8"	PTFE	12200636	416.40
	DN4	950 mm	300 l	1/4x3/8"	PTFE	12200637	416.40
	DN4	1100 mm	500 l	1/4x3/8"	PTFE	12200638	424.60
	DN4	1160 mm	1000 l	1/4x3/8"	PTFE	12200639	424.60
	DN4	1400 mm	1000 l	1/4x3/8"	PTFE	12200666	424.60
	DN4	500 mm	35 l	3/8x1/2"	PTFE	12200732	416.60
	DN4	540 mm	75 l	3/8x1/2"	PTFE	12200733	416.60
	DN4	710 mm	100 l	3/8x1/2"	PTFE	12200734	437.80
	DN4	950 mm	300 l	3/8x1/2"	PTFE	12200736	437.80
	DN4	1100 mm	500 l	3/8x1/2"	PTFE	12200737	447.40
	DN4	1160 mm	1000 l	3/8x1/2"	PTFE	12200738	447.40
	DN4	1400 mm	1000 l	3/8x1/2"	PTFE	12200739	447.40

Suction lines

Accessories

Suction lines

Rigid suction line, type GF-2, with foot valve DN4, level monitoring and pre-alarm with 2 switching points, switching distance ~ 60 mm, protection tube Ø40 mm, adjustable suction height by moving the K60 cover, hose clamp connections 4/6 for suction connection, hose grommet Ø4 mm for 2 return ducts, incl. 4500 mm PVC hose, electrical connection to dosing pump coded with socket M12x1 A

(Suitable adapter cables for pumps type LD / LK / LP Article no. 79407 can be found on page 1 - 290)

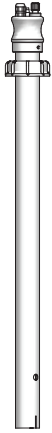

Suction line Type GF-2, rigid	Nominal width	Hose Øi/Øa	Material	Suction line Length	Part No.	Price [EUR]
PVC	DN4	4/6	PVC	460 mm	12200498	223.30
	DN4	4/6	PVC	630 mm	12200499	236.30
	DN4	6/9 and 1/4x3/8"	PVC	460 mm	12200535	271.30
	DN4	6/9 and 1/4x3/8"	PVC	630 mm	12200536	284.10
	DN4	6/12	PVC	460 mm	12200543	271.30
	DN4	6/12	PVC	630 mm	12200544	284.10

Rigid suction line, type SDL-2 with foot valve, level monitoring and pre-alarm with 2 switching points, switching distance ~ 18 mm (DN10) / ~ 34 mm (DN15), connection cable, 3-wire with pre-assembled strands, seals made of FPM and EPDM (selectable on site depending on medium)

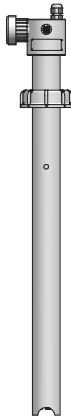

Suction line Type SDL-2, rigid	Nominal width	Suction line Length	Connection	Material Seals	Part No.	Price [EUR]
PVC	DN10	540 mm	G1 1/4 a	FPM and EPDM	12201168	344.40
	DN10	710 mm	G1 1/4 a	FPM and EPDM	12201169	344.40
	DN10	800 mm	G1 1/4 a	FPM and EPDM	12201170	344.40
	DN10	950 mm	G1 1/4 a	FPM and EPDM	12201171	344.40
	DN10	1100 mm	G1 1/4 a	FPM and EPDM	12201172	344.40
	DN15	540 mm	G1 1/4 a	FPM and EPDM	12201173	344.40
	DN15	710 mm	G1 1/4 a	FPM and EPDM	12201174	344.40
	DN15	800 mm	G1 1/4 a	FPM and EPDM	12201175	344.40
	DN15	950 mm	G1 1/4 a	FPM and EPDM	12201176	344.40
	DN15	1100 mm	G1 1/4 a	FPM and EPDM	12201177	344.40

Other lengths on request

Accessories	Suction lines
--------------------	----------------------

Fluid connection for suction line	Description	Material	Part No.	Price [EUR]
SDL-2 with union nut G1 1/4	Hose clamp connection for tube 9/15 mm	PVC	25918	53.60
	Hose clamp connection for tube 10/12 mm	PVC/PVDF	42103	54.30
	Hose clamp connection for tube 13/20 mm	PVC	38209	46.30
	Hose clamp connection for tube 16/24 mm	PVC/PVDF	39830	76.00
	Hose clamp connection for hose Ø9 mm	PVC	25921	22.60
	Hose clamp connection for hose Ø12 mm	PVC	92517	28.00
	Hose clamp connection for hose Ø16 mm	PVC	25936	22.60
	Hose clamp connection for hose Ø25 mm	PVC	35738	41.70
	Glue-in connection for pipe Ø20 female	PVC	25923	10.70
	Glue-in connection for pipe Ø16 male	PVC	27672	12.90
	Glue-in connection for pipe Ø20 male	PVC	25937	12.90
	Glue-in connection for pipe Ø25 male	PVC	33318	12.90
	Glue-in connection for pipe G3/8 male	PVC	25930	17.60
	Glue-in connection for pipe G1/2 male	PVC	25943	17.60
	Threaded connection 1/2" NPT male	PVC	39074	32.40
	Glue-in connection for pipe G3/4 male	PVC	33719	15.30
	Threaded connection for pipe G1 male	PVC	98539	18.80

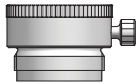

Barrel connection (permits continuously adjustable immersion depth)	Part No.	Price [EUR]
Clamping socket G2 for nominal pressure DN10	41358	55.20
Clamping socket 2" for nominal pressure DN10	41363	99.00
Clamping socket G2 for nominal pressure DN15	38548	55.20
Clamping socket 2" for nominal pressure DN15	38549	99.20
Reduction 2" Mauser a. - G2 i, PE	38485	77.40

Suction lines

Accessories

Suction lines

Rigid suction line, type SH, PVC suction line with foot valve



Suction line Type SH, rigid	Nominal width	Suction line		Material	Part No.	Price [EUR]
		Suction connection	Length			
PVC	DN10	Grommet Ø9	540 mm max.	PVC/FPM	12200354	143.90
	DN10	Grommet Ø9	750 mm max.	PVC/FPM	12200355	143.90
	DN10	Grommet Ø9	800 mm max.	PVC/FPM	12200356	143.90
	DN10	Grommet Ø9	1200 mm max.	PVC/FPM	12200357	143.90
	DN10	Pipe Ø16	1400 mm max.	PVC/FPM	12200358	143.90
	DN10	Pipe Ø16	1600 mm max.	PVC/FPM	12200250	143.90
	DN15	Grommet Ø16	540 mm max.	PVC/CSM	12200359	217.60
	DN15	Grommet Ø16	800 mm max.	PVC/CSM	12200361	217.60
	DN15	Grommet Ø16	1000 mm max.	PVC/CSM	12200362	217.60
	DN15	Grommet Ø16	1200 mm max.	PVC/CSM	12200363	217.60
	DN15	Grommet Ø16	1400 mm max.	PVC/CSM	12200364	217.60
	DN15	Pipe Ø20	1500 mm max.	PVC/CSM	12200001	217.60
	DN15	Pipe Ø20	2000 mm max.	PVC/CSM	12200331	217.60
	DN25	Grommet Ø25	1125 mm	PVC/CSM	12200365	347.80

Accessories Suction lines

Flexible suction line, type SL with foot valve and weighting, hose and cable length 2500 mm, level monitoring with 1 switching point, switch function: Closer with rising level, electrical connection to dosing pump with 3.5 mm jack plug
(fitting adapter cable for pumps of the type LD / LK / LP article no. 79407 can be found on page 1 - 290)

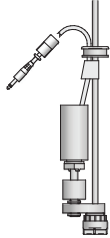

Suction line Type SL, flexible	Nominal width	Øi/Øa	Hose Material	Part No.	Price [EUR]
	DN4	4/6	Soft PVC	12228503	81.40
	DN6	6/12	PVC	12200503	106.10

Flexible suction line, type SL-2 with foot valve and weighting, adjustable length up to 1400 mm, hose length 2500 mm.
Level control with low level alert with 2 switching points switching distance ~ 30 mm switching function: Closer with rising level, electrical connection to dosing pump with A-coded plug connector M12x1,
(fitting adapter cable for pumps of the type LT / DE / DX article no. 79408 can be found on page 1 - 290)

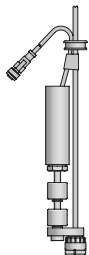

Suction line Type SL-2, flexible	Nominal width	Øi/Øa	Hose Material	Part No.	Price [EUR]
PVC	DN4	4/6	Soft PVC	12200500	135.70
	DN6	6/9	Soft PVC	12200501	135.70
	DN6	6/12	PVC	12200502	135.70
	DN6	9/12 and 3/8x1/2"	Soft PVC	12200677	218.60
PP	DN4	4/6	PE	12200608	212.30
	DN6	6/9	PE	12200609	212.30
	DN6	9/12	PE	12200682	267.50
	DN6	1/4x3/8"	PE	12200610	288.20
	DN6	3/8x1/2"	PE	12200683	288.20
PVDF	DN4	4/6	PTFE	12200611	317.20
	DN6	6/9	PTFE	12200612	317.20
	DN6	9/12	PTFE	12200679	429.80
	DN6	1/4x3/8"	PTFE	12200613	461.50
	DN6	3/8x1/2"	PTFE	12200680	461.50

Accessories Level control

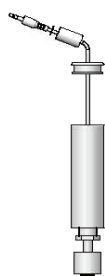

Flexible level control, type NB with ceramic weighting piece, adjustable length, switch function: Closer with rising level, 1 switching point, electrical connection to dosing pump with 3.5 mm jack plug, cable length 2500 mm (soft PVC, other materials available on request)
(fitting adapter cable for pumps of the type LD / LK / LP article no. 79407 can be found on page 1 - 290)

Level control	Part No.	Price [EUR]
Type NB, flexible		
PVC	12228048	47.80

Flexible level control, type NB with ceramic weighting piece, adjustable length, switch function: Closer with rising level, 2 switching points, switching separation distance ~ 34 mm, electrical connection to dosing pump with 3.5 mm jack plug, cable length 2500 mm (soft PVC, other materials available on request) (fitting adapter cable for pumps of the type LD / LK / LP article no. 79407 can be found on page 1 - 290)

Level control	Part No.	Price [EUR]
Type NB-2, flexible		
PVC	12234528	82.90

Flexible level control type NB-2 with ceramic weighting piece, adjustable length, level control with low level alert with 2 switching points switching distance ~34 mm with PVC, ~18 mm with PP and PVDF, switching function: NO contact at rising level, Electrical connection to dosing pump with socket M12x1, A coded, cable length 3000 mm (soft PVC, with PP and PVDF version with PTFE protective caps)

(Suitable adapter cables for pumps type LT / DE / DX Article no. 79408 can be found on page 1 - 290)

Level control	Part No.	Price [EUR]
Type NB-2, flexible		
PVC	12200504	98.90
PP	12200653	130.80
PVDF	12200652	178.00

Rigid suction line, with level control, type ND with adjustable length, PVC float switch, switching function: Closer with rising level, electrical connection to dosing pump with 3.5 mm jack plug (fitting adapter cable for pumps of the type LD / LK / LP article no. 79407 can be found on page 17)



Level control	Level control	Part No.	Price [EUR]	
Type ND, rigid	Length for tank			
PVC	100 mm	12200549	78.20	
	200 mm	12233723	78.20	
	500 mm	35 l	12200550	85.20
	540 mm	75 l	12200551	85.20
	710 mm	100 l	12200552	85.20
	800 mm	200 l	12200553	88.60
	950 mm	300 l	12200554	88.60
	1100 mm	500 l	12200555	88.60
	1160 mm	1000 l	12200556	88.60
	1400 mm	12228080	88.60	

Accessories Level control

Rigid level control type ND-2 with adjustable length,
 level control with low level alert with 2 switching points switching distance: ~34 mm with PVC, ~18 mm with
 PP and PVDF, switching function: Closer with rising level, electrical connection to dosing pump with A-coded
 plug connector M12x1,
 (fitting adapter cable for pumps of the type LT / DE / DX article no. 79408 can be found on page 1 - 290)



Level control Type ND-2, rigid	Length	Level control for tank	Part No.	Price [EUR]
PVC	200 mm		12200508	130.80
	500 mm	35 l	12200509	130.80
	540 mm	75 l	12200510	135.00
	710 mm	100 l	12200511	135.00
	800 mm	200 l	12200512	140.00
	950 mm	300 l	12200513	140.00
	1100 mm	500 l	12200514	140.00
	1160 mm	1000 l	12200794	140.00
	1400 mm		12200795	140.00
PP	200 mm		12200670	214.60
	500 mm	35 l	12200671	214.60
	540 mm	75 l	12200672	219.00
	710 mm	100 l	12200673	219.00
	800 mm	200 l	12200674	224.10
	950 mm	300 l	12200675	224.10
	1100 mm	500 l	12200676	224.10
	1160 mm	1000 l	12200788	224.10
	1400 mm		12200789	224.10
PVDF	200		12200654	273.50
	500	35 l	12200655	273.50
	540	75 l	12200656	281.90
	710	100 l	12200657	281.90
	800	200 l	12200658	287.60
	950	300 l	12200659	287.60
	1100	500 l	12200660	287.60
	1400		12200791	287.60

Level monitoring with multiple switching available on request.

Accessories



Suction hose	Dimensions Øi/Øa	Part No.	Price per m [EUR]
PVC, soft	4/6	97181	2.70
	6/8	97601	2.90
	6/9	97687	2.70
	1/4x3/8"	97948	8.30
	1/4x7/16"	97949	11.10
	9/12	97894	4.10
	3/8x1/2"	97950	14.20

Pressure hose	Dimensions Øi/Øa	Pressure resistance at 20 °C	Part No.	Price per m [EUR]
PE	4/6	13 bar	97128	2.90
	5/8	14 bar	97829	2.90
	6/8	8 bar	97175	2.90
	6/9	10 bar	97636	2.90
	1/4x3/8"	10 bar	97742	4.50
	8/12	10 bar	97124	3.00
	9/12	9 bar	97728	4.20
	3/8x1/2"	9 bar	97871	4.50
PTFE	4/6	18 bar	97389	5.80
	6/8	8 bar	97620	8.80
	6/9	18 bar	97758	19.60
	1/4x3/8"	18 bar	97841	20.00
	9/12	14 bar	97869	32.00
	3/8x1/2"	14 bar	97872	29.30
PTFE, violet	4/6	18 bar	97823	18.90
	6/9	18 bar	97897	35.30
PTFE, orange	4/6	18 bar	97824	18.90
	6/9	18 bar	97898	35.30
PVC, PA fabric reinforced	6/12	16 bar	97120	2.70
	9/15	11 bar	97121	3.50
	13/20	13 bar	97802	6.00
	16/24	7 bar	97390	6.80
	25/34	6 bar	97171	9.10

Hose coupling	For hoses of the dimensions Øi/Øa	Part No.	Price per m [EUR]
PVC	6/12	29859	19.10
	9/15	32466	16.70
	4/6	98573	20.10
	6/8	99551	37.50
	6/9	41623	20.10

Accessories

Screw cap PE black for delivery package with thread K 60x6

Screw cap	For type	Bore	Part No.	Price per m [EUR]
PE	Suction lines SA and SL and level monitoring NB	Ø25	29836	16.90
	Suction lines with G 1 screw-in thread (SG and SC)	Ø33.5	19800	11.40
	Suction lines with protective pipe Ø40 (GF)	Ø41	34431	12.00

Accessories Foot valves

Foot valve, type FA with hose clamp connection



Foot valve Type FA	Nominal width	Hose connection	Material seal	Part No.	Price [EUR]
PVC	DN10	Ø13/20	FPM		see type FK
	DN10	Ø13/20	EPDM		see type FK
PP	DN10	Ø13/20	FPM		see type FK
	DN10	Ø13/20	EPDM		see type FK
PVDF	DN10	Ø13/20	PTFE	12200820	247.20
	DN15	Ø16/24	PTFE	12200827	325.80

Foot valve, type FB with hose nozzle



Foot valve Type FB	Nominal width	Hose connection	Material seal	Part No.	Price [EUR]
PVC	DN6	Ø6 internal	-	12225279	45.70
	DN10	Ø9 internal	FPM	12200204	78.60
	DN10	Ø9 internal	EPDM	12225394	73.00
	DN15	Ø16 internal	FPM	12226242	132.00
	DN15	Ø16 internal	EPDM	12225396	126.50
	DN25	Ø25 internal	FPM	12200831	247.40
	DN25	Ø25 internal	EPDM	12226240	241.80
	Stainless steel	DN4	Ø4 internal	FPM	12226219
DN4		Ø4 internal	EPDM	12200832	100.80
DN6		Ø6 internal	FPM	12200284	174.10
DN6		Ø6 internal	EPDM	12226223	168.80
DN10		Ø9 internal	FPM	12200833	228.00
DN10		Ø9 internal	EPDM	12226227	222.40
DN15		Ø16 internal	FPM	12200834	408.40
DN15		Ø16 internal	EPDM	12226239	402.80
DN25		Ø25 internal	FPM	12200835	561.90
DN25		Ø25 internal	EPDM	12226241	556.30

Accessories

Foot valves

Foot valve, type FC with stick-on connection

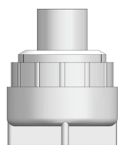

Foot valve Type FC	Nominal width	Hose connection	Material seal	Part No.	Price [EUR]
PVC	DN4	Ø6	-	12224380	20.70
	DN6	Ø12	-	12224397	30.70
	DN10	Ø16	FPM	12224314	71.80
	DN10	Ø16	EPDM	12224411	61.30
	DN10	Ø20	FPM		see type FK
	DN10	Ø20	EPDM		see type FK
	DN15	Ø20	FPM	12229682	127.30
	DN15	Ø20	EPDM	12224435	115.40
	DN15	Ø25	FPM		see type FK
	DN15	Ø25	EPDM		see type FK
	DN25	Ø32	FPM	12224421	234.40
	DN25	Ø32	EPDM	12224423	226.50
	DN25	Ø40	FPM	12200829	304.90
	DN25	Ø40	EPDM	12200830	300.60

Foot valve, type FC with welded connection

Foot valve Type FC	Nominal width	Hose connection	Material seal	Part No.	Price [EUR]
PP	DN10	Ø20	FPM		see type FK
	DN10	Ø20	EPDM		see type FK
	DN15	Ø20	FPM	12200818	242.10
	DN15	Ø20	EPDM	12200819	236.80
PVDF	DN10	Ø20	PTFE	12200821	358.80
	DN15	Ø20	PTFE	12200825	512.40
	DN15	Ø25	PTFE	12200826	520.40

Accessories **Foot valves**

Foot valve, type FD with threaded connection

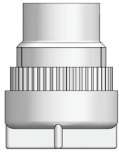

Foot valve Type FD	Nominal width	Connection for pipe with thread	Material seal	Part No.	Price [EUR]
PP	DN25	G1	FPM	12200822	249.40
	DN25	G1	EPDM	12200823	245.10
PVDF	DN4	G1/4	-	12229468	53.50
	DN6	G1/4	-	12229767	69.00
	DN25	G1	PTFE	12200824	490.80
Stainless steel	DN4	G1/4	FPM	12200518	95.60
	DN4	G1/4	EPDM	12200573	95.60
	DN6	G1/4	FPM	12200283	120.50
	DN6	G1/4	EPDM	12224398	119.30
	DN10	G3/8	PTFE	12200797	198.50
	DN10	G1/2	FPM	12200836	256.30
	DN10	G1/2	EPDM	12224412	253.00
	DN10	G1/2	PTFE	12200116	265.50
	DN15	G1/2	FPM	12200203	339.60
	DN15	G1/2	EPDM	12224436	339.60
	DN15	G1/2	PTFE	12200800	351.90
	DN15	G3/4	PTFE	12200801	468.00
	DN25	G1	FPM	12224315	475.50
	DN25	G1	EPDM	12224424	475.50
DN25	G1	PTFE	12200802	515.90	

Foot valve, type FK (connection set) with hose clamp and stick-on connection

Foot valve Type FK	Nominal width	Connection for hose or pipe	Material seal	Part No.	Price [EUR]
PVC	DN10	Ø13/20, Ø16 and Ø20	FPM	12200804	118.70
	DN10	Ø13/20, Ø16 and Ø20	EPDM	12200805	115.10

Foot valve, type FK (connection set) with hose clamp and welded connection

Foot valve Type FK	Nominal width	Connection for hose or pipe	Material seal	Part No.	Price [EUR]
PP	DN10	Ø13/20, Ø16 and Ø20	FPM	12200814	192.60
	DN10	Ø13/20, Ø16 and Ø20	EPDM	12200815	189.30

Foot valve, type FK (connection set) with hose clamp, threaded and welded connection

Foot valve Type FK	Nominal width	Connection for hose or pipe	Material seal	Part No.	Price [EUR]
PP	DN15	Ø16/24	FPM	12200816	231.10
	DN15	G1/2 i and Ø25	EPDM	12200817	228.10

Standard accessories

Adapter

Adapter, for pump type LD / LK / LP, is required when using older suction lines with 3.5 mm jack plug

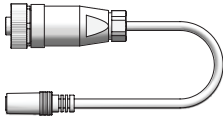

Adapter A-coded	Description	Cable length	Part No.	Price [EUR]
Pump-side M12x1 socket	3.5 mm stereo jack coupling	0.2 m	79407	25.10

Adapter for pump types LT / DE / DX when using a suction line with a M12x1 socket.

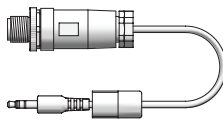

Adapter A-coded	Description	Cable length	Part No.	Price [EUR]
Pump-side M12x1 coupling plug	3.5 mm stereo jack	0.2 m	79408	25.10

Coupling plug,

to extend the existing connection cable of a suction line.



Coupling plug A-coded	Description	Part No.	Price [EUR]
Pump-side M12x1 coupling plug	Screw terminal connection, 4-pin	75008	15.50