

# LOADCELL TYPE U2D1-3K to 20K

## SPECIFICATIONS

### ● PERFORMANCE

Rated capacity(R.C.)	: 29.42 N { 3 kgf }
	58.84 N { 6 kgf }
	98.07 N { 10 kgf }
	147.1 N { 15 kgf }
	196.1 N { 20 kgf }
Safe overload	: 200 %R.C.
△ Ultimate overload	: 300 %R.C.
△ Rated output(R.O.)	: 2 mV/V±0.2mV/V
Non-linearity	: 0.015 %R.O.
Hysteresis	: 0.015 %R.O.
Repeatability	: 0.02 %R.O.
△ Creep	: U2D1-3K : 0.03 %R.O./20min
	U2D1-6K ~ 20K : 0.02 %R.O./20min
△ Creep recovery	: U2D1-3K : 0.03 %R.O./20min
	U2D1-6K ~ 20K : 0.02 %R.O./20min

### ● ELECTRICAL

△ Recommended excitation	: 12 V or LESS
Maximum excitation	: 20 V
△ Zero balance	: ±0.1mV/V
△ Input terminal resistance	: 420 Ω <sup>+30</sup> / <sub>-20</sub> Ω
Output terminal resistance	: 350 Ω ± 5 Ω
Insulation resistance	: 2000 MΩ or more

### ● TEMPERATURE

Compensated temperature range	: -10 °C to 50 °C
Safe temperature range	: -10 °C to 50 °C
Temperature effect	: 0.04 %R.O./10°C
on zero balance	
Temperature effect	: 0.012 %LOAD/10°C
on output	

### ● THE OTHERS

△ Cable Element	: φ 3.2 mm 4 core shield 30 cm
Weight	: Alloy Aluminum
	: Approx. 350 g

### Circuit

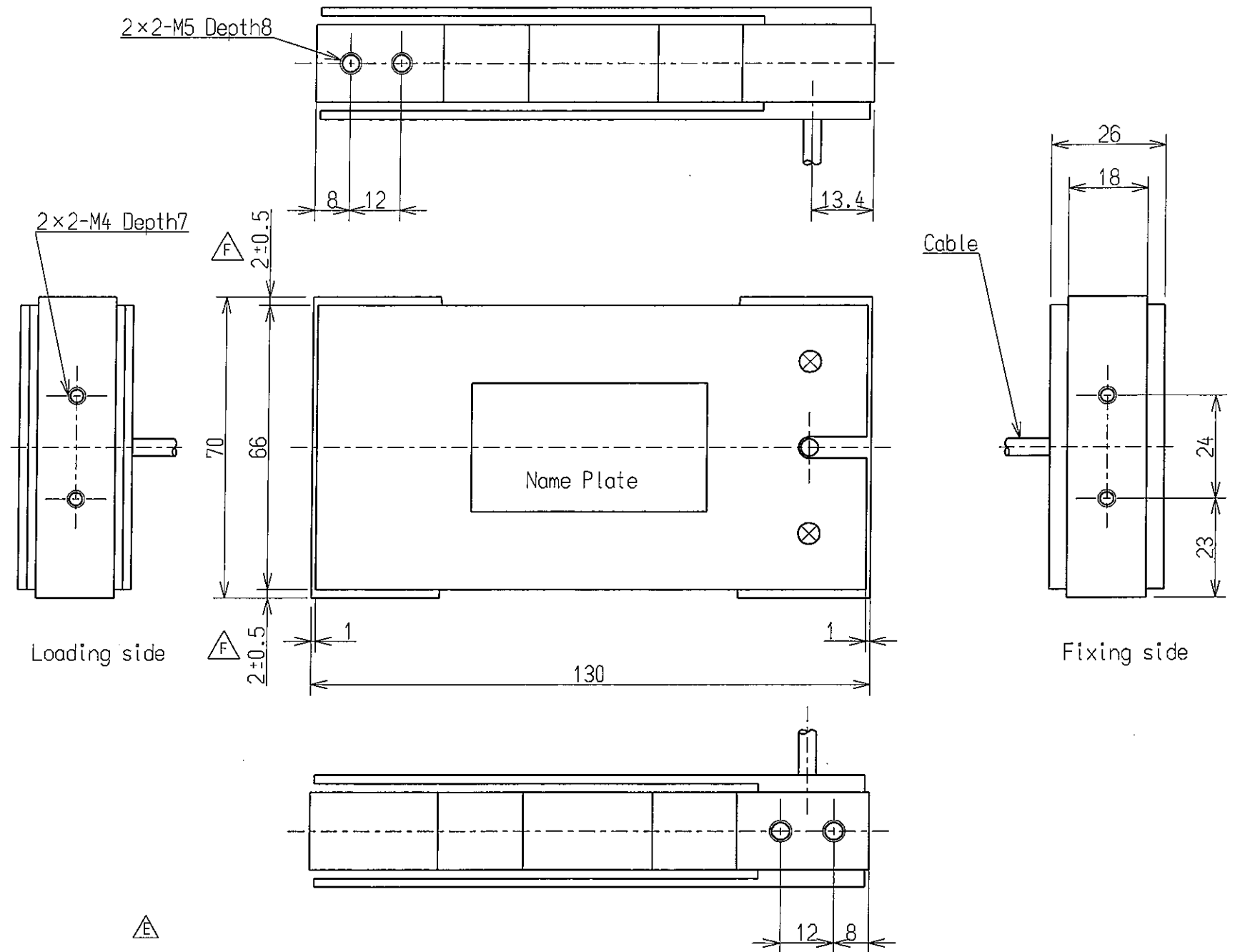
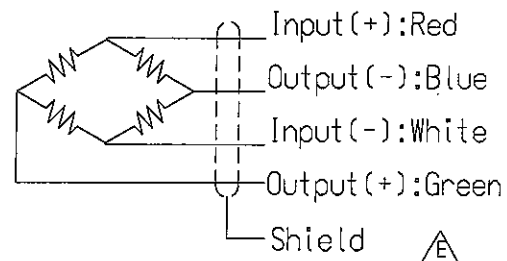

### ● Eccentric error

Size of loading plate installation : Max. 400mm × 600mm  
 : Be sure to adjust center of loading plate to center of loadcell.  
 Accuracy : 0.02%R.O. with 1/2 rated load applied at 150mm from center.

### △ MAX. SIZE OF LOADING PLATE

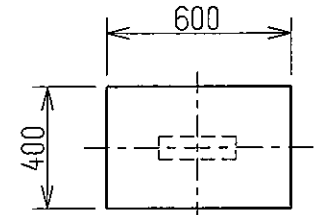

					<b>ミネベア株式会社</b> MINEBEA CO.,LTD. <b>計測機器事業部</b>			単位 UNIT mm 尺度 SCALE Free	材質 MATERIAL 表面粗さ SURF.ROUGH. 熱処理 HEAT TREAT. 表面処理 FINISH	作成日 DATE 1983.12.14 品名 DESCRIPTION <b>OUTLINE</b> 品番 PART NO.(MODEL NO.) U2D1-3K TO 20K 図番 DRAWING NO. K102903-2	葉番 SHEET 改訂 REV. F
F	2009.1.9	KN09-0005	T.TATSUTA	A.MURO	APPROVED	CHECKED	DRAWN	寸法 L	公差		
E	2003.5.6	KN03-0228	A.YOSHIDA	A.MURO				<L≤4	±0.1		
D	1997/06/02	KN97-0169	HASUIKE	F.IDE				4<L≤16	±0.2		
								16<L≤63	±0.3		
								63<L≤250	±0.5		
								250<L≤1000	±0.8		
								角度 DEG	±0.5		