

Spare Parts List Breather Dryer BDE

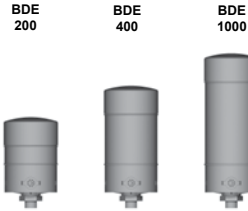

1. MAINTENANCE

1.1 GENERAL

Please follow the maintenance instructions!

1.2 COMMISSIONING

Check that the correct filter cartridge is fitted.

When the filter is due to be changed, the colour changes from dark red to light orange.

1.3 TOOLS REQUIRED FOR MAINTENANCE

- Strap wrench (1 or 2 pieces)

Connection (thread)	Ext. hex.	Tightening torque
1" Slip Fit Ø 33.4	SW 50	-
G1"	SW 50	20 Nm
M42 x 2	SW 50	20 Nm
NPT 1"	SW 50	20 Nm
NPT 2"	SW 65	20 Nm
Flange adapter DIN 24557/ T2	SW 50	-

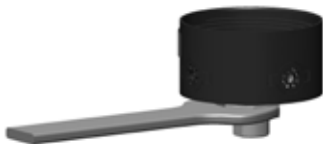

2. CHANGING THE CARTRIDGE

In order to ensure reliable function, the entire cartridge must be replaced.

2.1 REMOVING THE CARTRIDGE

1. Apply open-jaw wrench to ext. hex. (alternatively: strap wrench on bottom section).



2. Unscrew filter cartridge from the bottom section of the BDE anticlockwise using a strap wrench.

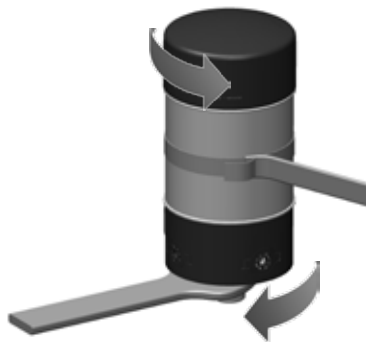

3. Examine bottom section, especially sealing surfaces, for mechanical damage.

2.2 CARTRIDGE INSTALLATION

1. When fitting a new cartridge, check that the designation corresponds to that of the old cartridge.
2. Screw in the cartridge fully manually.



3. Then turn the cartridge back again slightly (max. 1/8 turn).

1/8



3. SPARE PARTS

3.1 SPARE PARTS DRAWING BDE

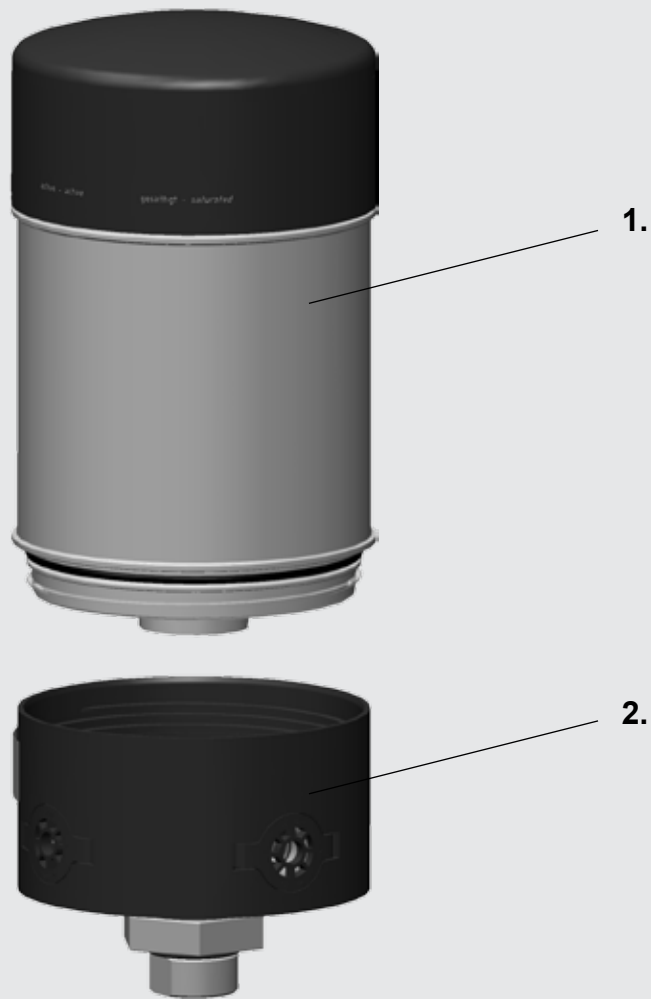

3.2 SPARE PARTS LIST BDE

Item	Designation	BDE
1.	Cartridge	
	BDE 200 X 2 W 0.0	01299653
	BDE 400 X 2 W 0.0	01299654
	BDE 1000 X 2 W 0.0	01299655
2.	Bottom section	
	Bottom section E BDE G 1.0 (G 1")	01301705
	Bottom section E BDE N 1.0 (NPT 1")	01301703
	Bottom section E BDE N 2.0 (NPT 2")	01301704
	Bottom section E BDE M 1.0 (M42x2)	01305475
	Bottom section E BDE S 1.0 (Slip Fit 1")	01305476
	Bottom section E BDE F 1.0 (Flange)	01305477
	Bottom section E BDE G 1.0 /-RV0.003) (G 1")	01301708
	Bottom section E BDE N 1.0 /-RV0.003) (NPT 1")	01301706
	Bottom section E BDE N 2.0 /-RV0.003) (NPT 2")	01301707
	Bottom section E BDE M 1.0 /-RV0.003) (M42x2)	01305478
	Bottom section E BDE S 1.0 /-RV0.003) (Slip Fit 1")	01305479
	Bottom section E BDE F 1.0 /-RV0.003) (Flange)	01305480
	Bottom section E BDE G 1.0 /-RV0.02) (G 1")	01305481
	Bottom section E BDE N 1.0 /-RV0.02) (NPT 1")	01305482
	Bottom section E BDE N 2.0 /-RV0.02) (NPT 2")	01305483
	Bottom section E BDE M 1.0 /-RV0.02) (M42x2)	01305484
	Bottom section E BDE S 1.0 /-RV0.02) (Slip Fit 1")	01305485
	Bottom section E BDE F 1.0 /-RV0.02) (Flange)	01305486

Other spare parts on request

4. MAINTENANCE INSTRUCTIONS

4.1 USER INSTRUCTIONS FOR FILTERS



Note

It is the responsibility of the operator to comply with the water regulations of the country concerned.



Caution

Statutory accident prevention regulations, safety regulations and safety data sheets for fluids must be observed.



Caution

When working on, or in the vicinity of, hydraulic systems, naked flames, sparks and smoking are forbidden.



Caution

Hydraulic oils and water-polluting fluids must not be allowed to enter the soil or watercourses or sewer systems. Please ensure safe and environmentally friendly disposal of hydraulic oils. The relevant regulations in the country concerned with regard to ground water pollution, used oil and waste must be complied with.

4.2 MAINTENANCE, GENERAL

This section describes maintenance work which must be carried out periodically. The operational safety and life expectancy of the filter, and whether it is ready for use, depend to a large extent on regular and careful maintenance.

4.3 MAINTENANCE MEASURES

- Spare parts must fulfil the technical requirements specified by the manufacturer.
- This is always ensured when using original HYDAC spare parts.
- Tools, working area and equipment are to be kept clean.
- After disassembling the filter, clean all parts, check for damage or wear and replace parts if necessary.
- When changing a filter element, a high level of cleanliness must be observed!

4.4 INTERVAL BETWEEN ELEMENT CHANGES

When the filter is due to be changed, the colour changes reliably from red to light orange.

Customer Information in respect of Machinery Directive 2006/42/EC

Hydraulic filters are defined as fluid power parts / components and are therefore excluded from the scope of the Machinery Directive, sections 1.4.1 - 1.4.3. They do not bear the CE mark.

Before using these components, ensure compliance with the specifications provided by HYDAC Filtertechnik. The specifications also contain information on the relevant essential health and safety requirements (based on Machinery Directive 2006/42/EC).

We hereby declare that the filters are intended to be incorporated into machinery within the terms of the Directive 2006/42/EC. It is prohibited to put the filters into service until the machinery as a whole is in conformity with the provisions of the Machinery Directive.

SERVICE ADDRESSES

HYDAC Service GmbH
Postfach 1251
D-66273 Sulzbach / Saar

Works address:
Friedrichsthaler Straße 15
D-66540 Neunkirchen / Saar

ServiCenter:
Tel.: +49 (0) 6897 / 509-883
Fax.: +49 (0) 6897 / 509-324

Customer service:
Tel: +49 (0) 6897 / 509-412
Fax: +49 (0) 6897 / 509-324

NOTE

The information in this brochure relates to the operating conditions and applications described. For applications or operating conditions not described, please contact the relevant technical department. Subject to technical modifications.