

 PM Motor
 PG Type

Applications

Home electric appliances : Air-conditioners
 OA Equipment : Printers / Photocopiers
 Power Tools : Drills / Drivers

Reference Characteristics

| | | |
|---------------------------|----------------------|---------|
| Motor Size | PG15S-020 | |
| Reduction Ratio | 1/50 | 1/102.5 |
| Drive Characteristics | BIPOLAR CONST. VOLT. | |
| Drive Voltage | 5[V] | |
| Drive Method | 2-2 PHASE | |
| Step Angle (2phase drive) | 0.36° | 0.175° |
| DC Resistance | 10[Ω] | |
| Insulation Resistance | 100M[Ω] MIN | |
| Dielectric Strength | AC 500[V] 1[min] | |
| Class of Insulation | CLASS B | |
| Operating Temp. | -10[°C] ~ 50[°C] | |
| Storage Temp. | -30[°C] ~ 80[°C] | |
| Operating Hum. | 20[%] RH ~ 90[%] RH | |

Torque Characteristics

PG15S-020 Reduction Ratio 1/50

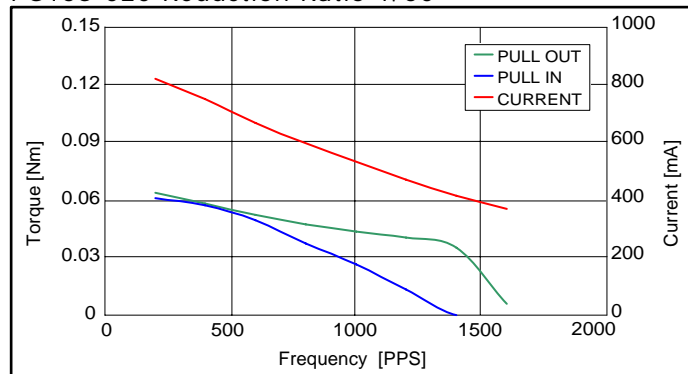

PG15S-020 Reduction Ratio 1/102.5

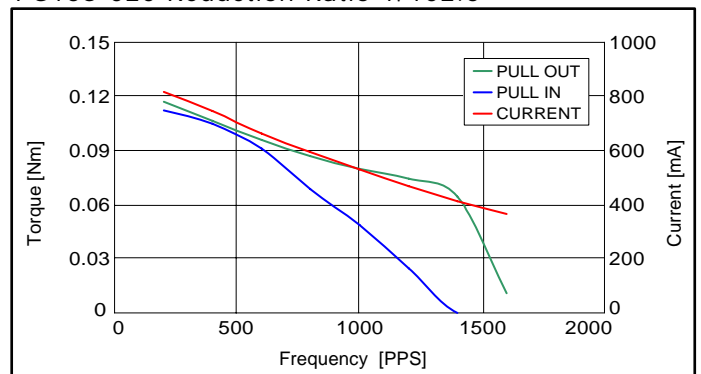

These torque values are reference only. Heat radiation conditions and temperature rise effect by duty are different on each equipment, therefore please select motors after considering the heat conditions in the actual equipment.

Dimensions

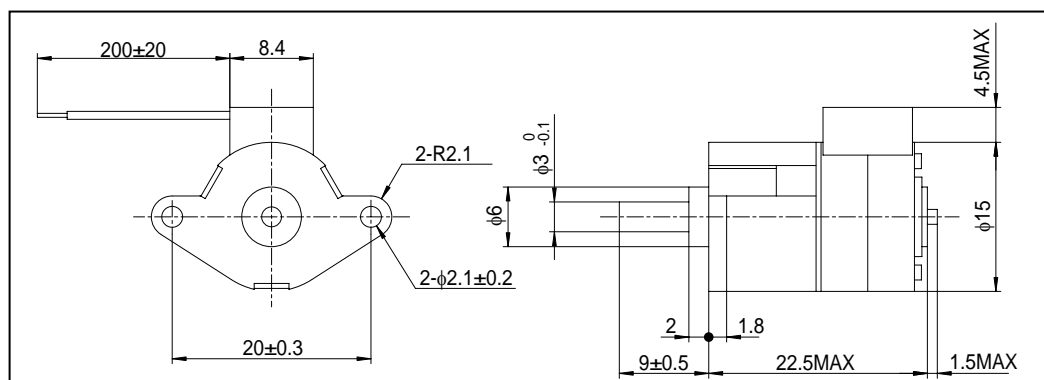

The dimensions shown are for reference purpose and can be modified to your requirements. Contact our Engineering Department for details.